

Gerät entkalken

Dauer ca. 40 Minuten

Benötigtes Material:
Entkalkungstabletten
 Packung à 3x3 Stück (Art. 61848)



Diese Kurzanleitung ersetzt nicht die »Bedienungsanleitung WE6«. Lesen und beachten Sie unbedingt zuerst die Sicherheits- und Warnhinweise, um Gefahren zu vermeiden.

Voraussetzung:



»Entkalkung«



Starten

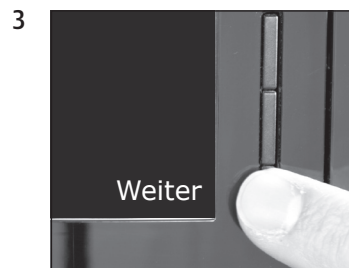

Weiter

»Restwasserschale leeren«

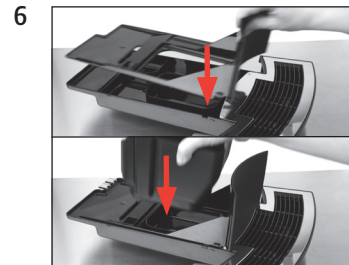
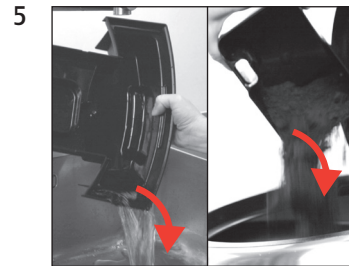
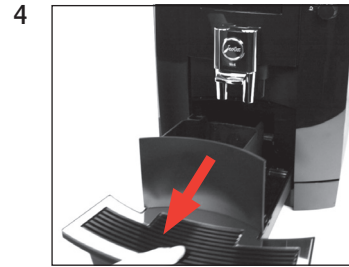

»Mittel in Tank«

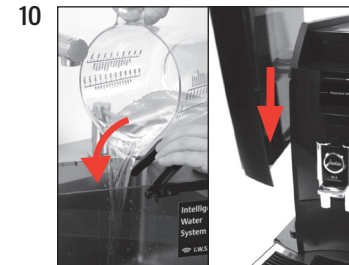
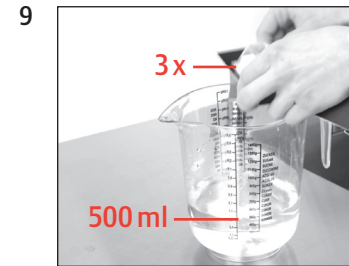
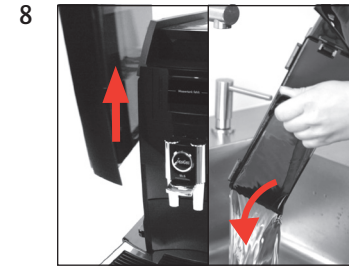

»Drehknopf öffnen«

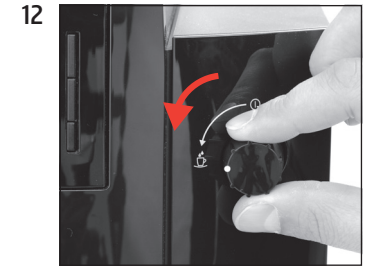

»Gerät entkalkt«
 »Drehknopf schließen«

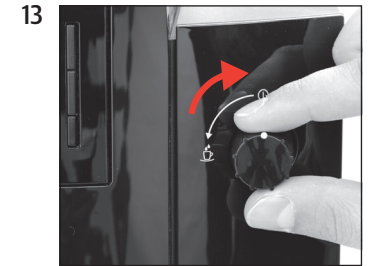

»Gerät entkalkt«
 »Restwasserschale leeren«

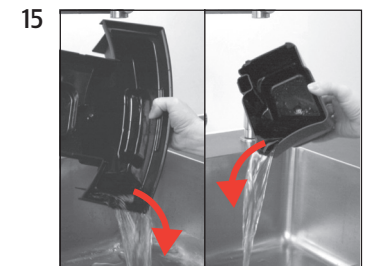
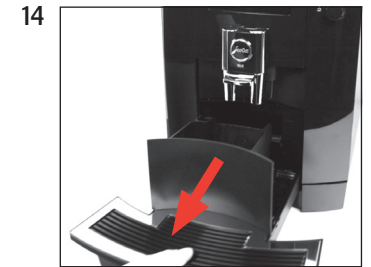



»Wassertank füllen«

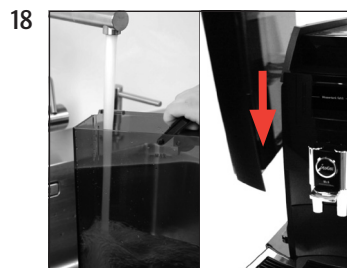
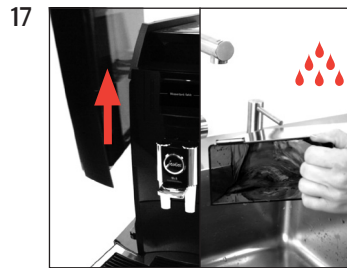

»Drehknopf öffnen«

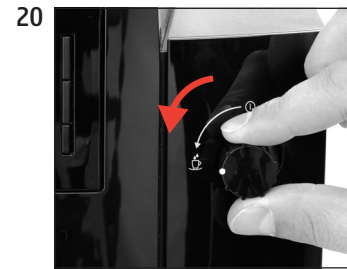

»Gerät entkalkt«
»Drehknopf schließen«

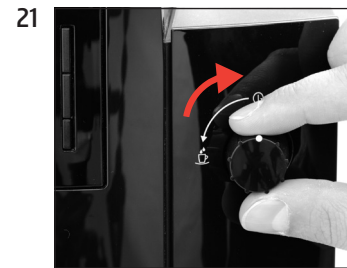

»Gerät entkalkt«
»Gerät spült«
»Restwasserschale leeren«

